

OBJECTIVES-

- Creating 'portable' schools
- Offering alternatives for schools facing evictions in Kenya
- Work with a new generation of youth who are interested in construction
- Allow students to become a part of the process
- Allow youth who couldn't afford to go to school a chance to get into construction

UNTAMED ARCHITECTURE

PRIMARY SCHOOL CLASSROOM

GRADES 1-5

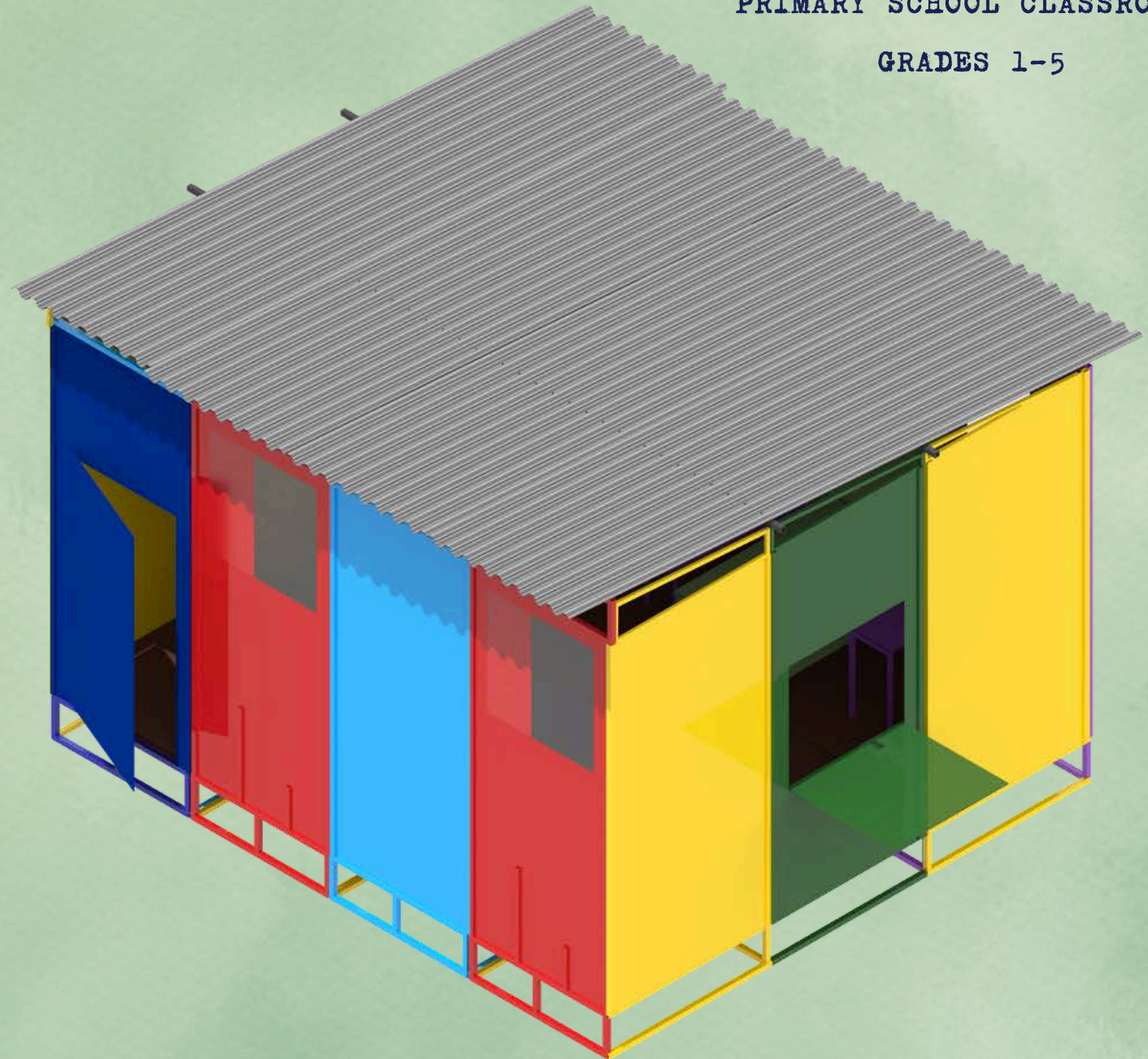

A significant challenge facing private schools providing critically needed educational services to hundreds of thousands of underprivileged children in the informal settlements (slums) of Kenya, and many other less developed countries, is the constant threat of eviction from the land that they are built upon, resulting in the loss of all infrastructural assets that the school possess. Recognising this challenge, the EJ Rihoy Trust, in collaboration with a local partner organizations, Earth Angels and St Stevens school, set out to see how it could be addressed in the most cost-effective and locally appropriate manner. Kenyan architect, Georgia Fernandes (Untamed Architecture, Kenya), designed and managed all aspects of the project, providing her invaluable skills and oversight on a pro-bono basis.

The outcome - the Mobile Classroom Unit - introduces a modular, color-coded classroom kit that can be assembled in just eight hours by unskilled labor with no prior construction experience, allowing for easy setup and adaptability. It is constructed and manufactured locally, using locally available and easily sourced materials and at a cost of £1,700 per unit accommodating 18 students, is approximately 80% cheaper to build than the standard brick and mabati (corrugated iron) classroom unit. It also accommodates design interventions that allow for rain-water collection, temperature regulation and cooling.

In addition to serving as a classroom, the structure can function as a food distribution center, community gathering space, and, with this specific prototype, a space for local women to establish a tailoring workshop when the building is not in use as a class-room.

By involving the community in the building process, construction aimed to inspire unemployed local youth, promoting a sense of ownership and pride and providing them with new skills.

UNTAMED ARCHITECTURE

PRIMARY SCHOOL CLASSROOM

GRADES 1-5

Kit of Parts

Number of People Recommended
for assembly- 5

Est Time to Assemble- 6 Hours

Class Fits- 18

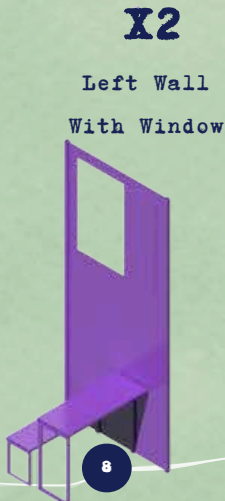
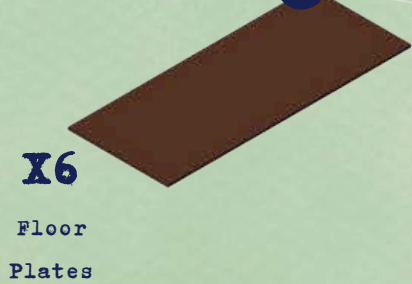
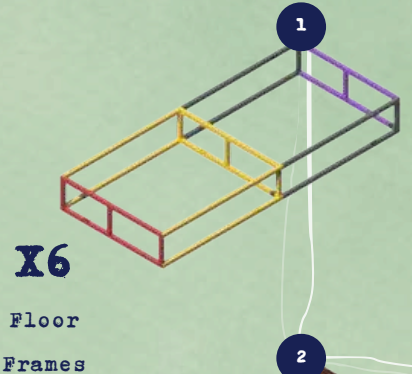

X2
Pickup Trucks for
transportation

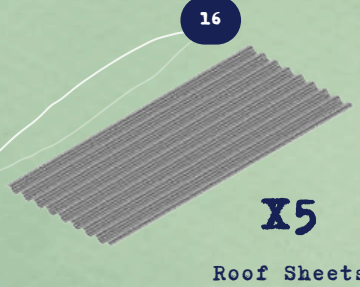
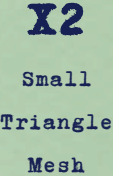
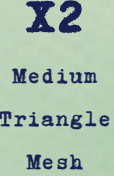

X110
4" Bolts



X50
5" Bolts



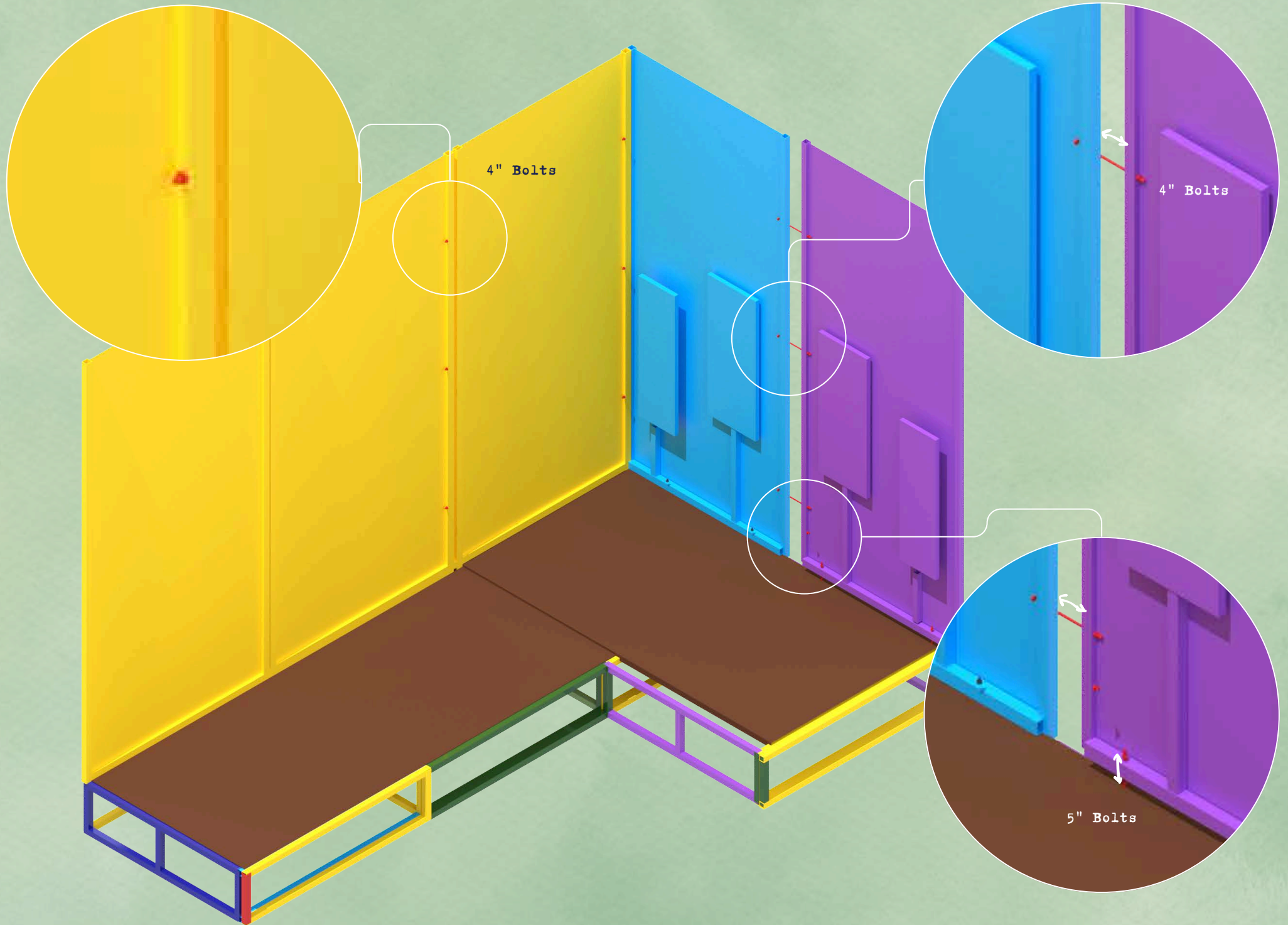

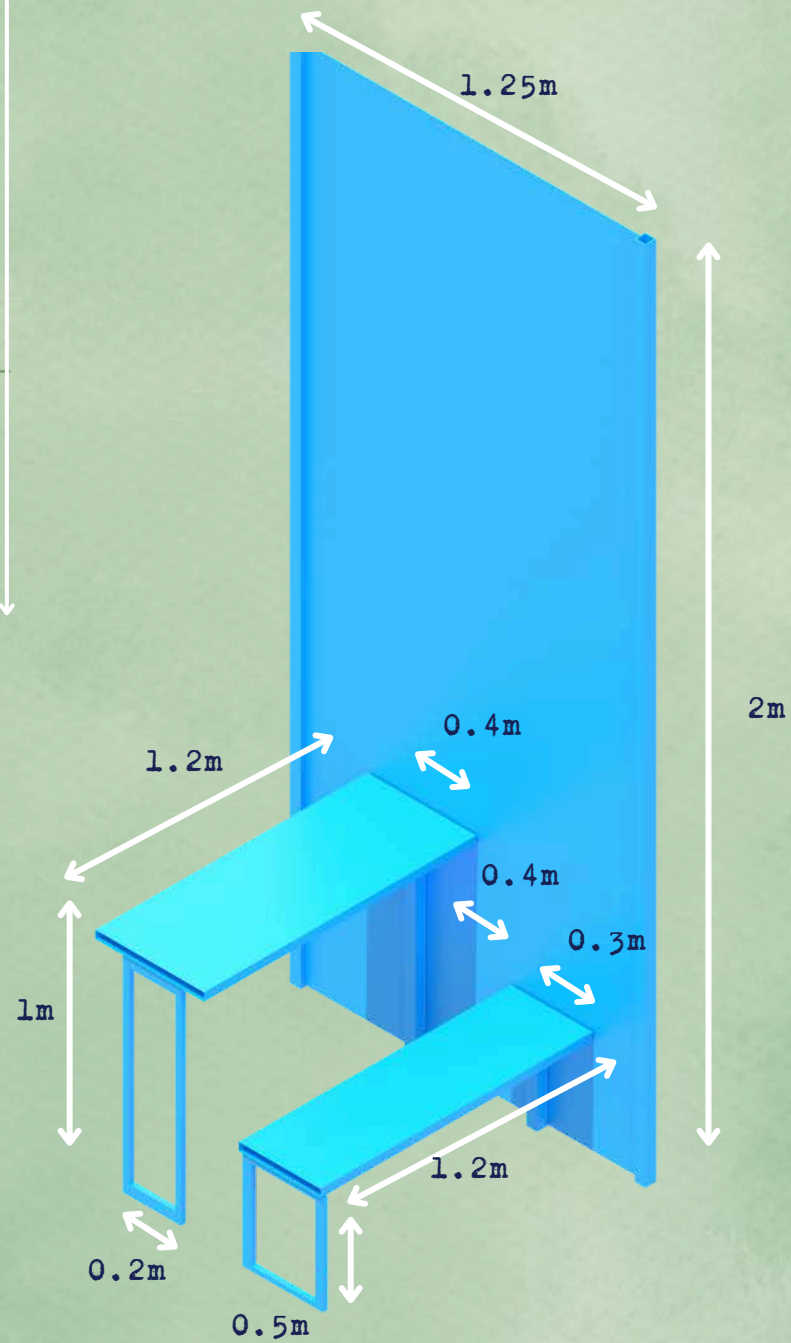
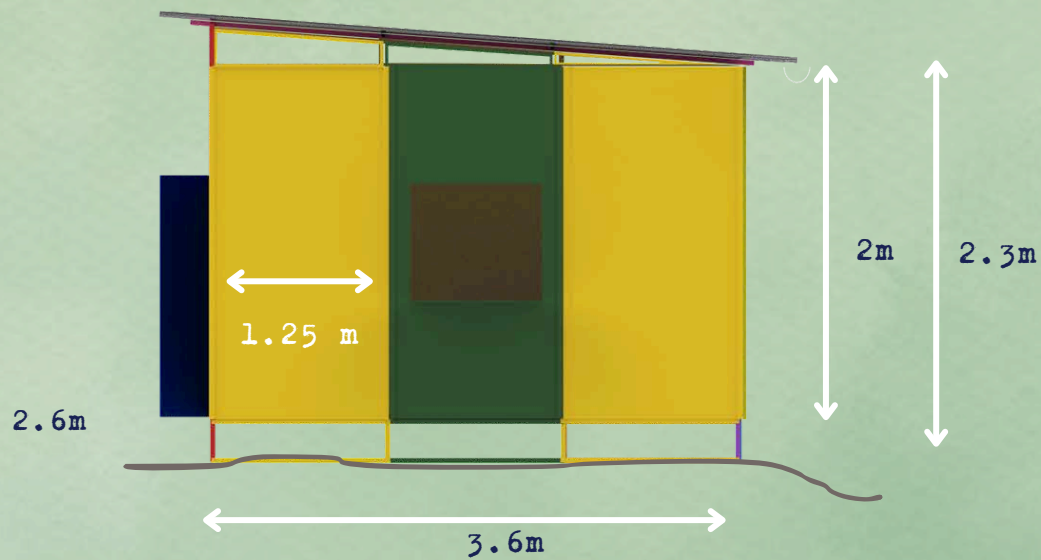
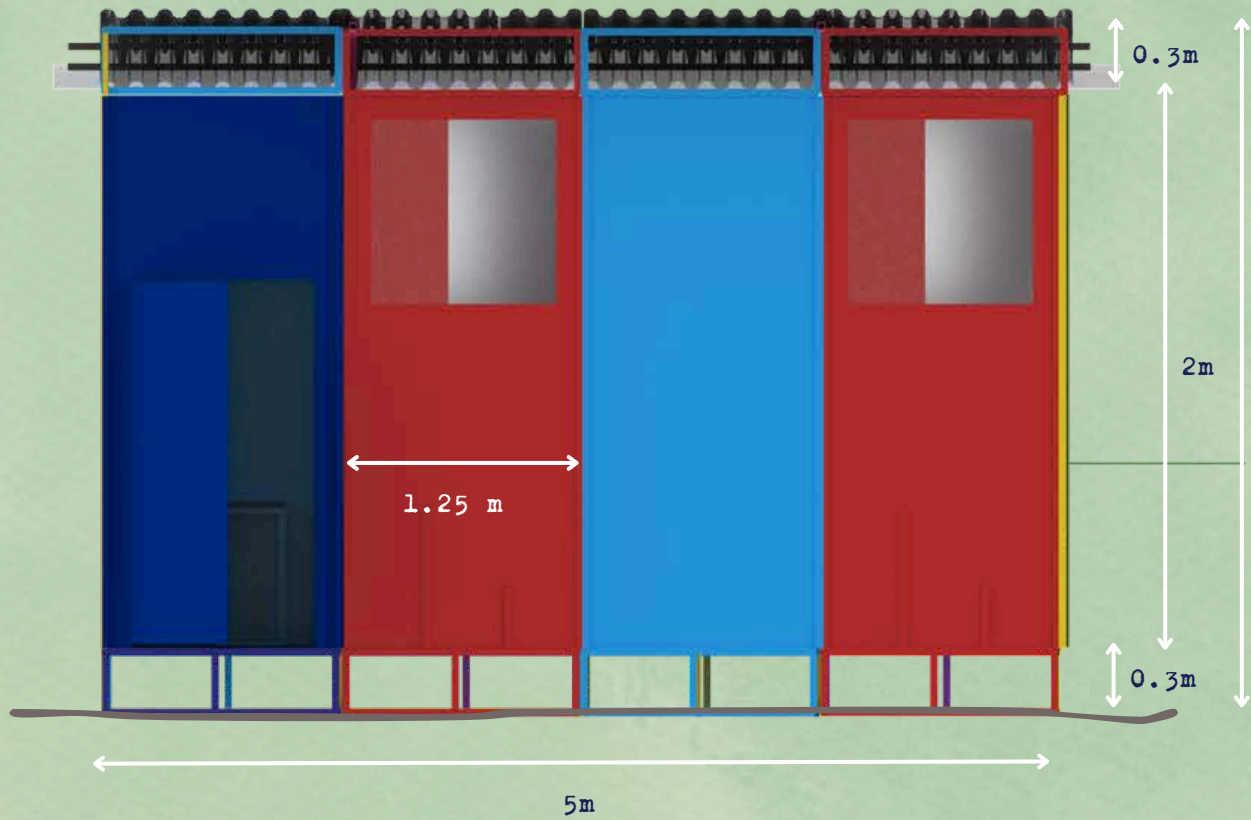

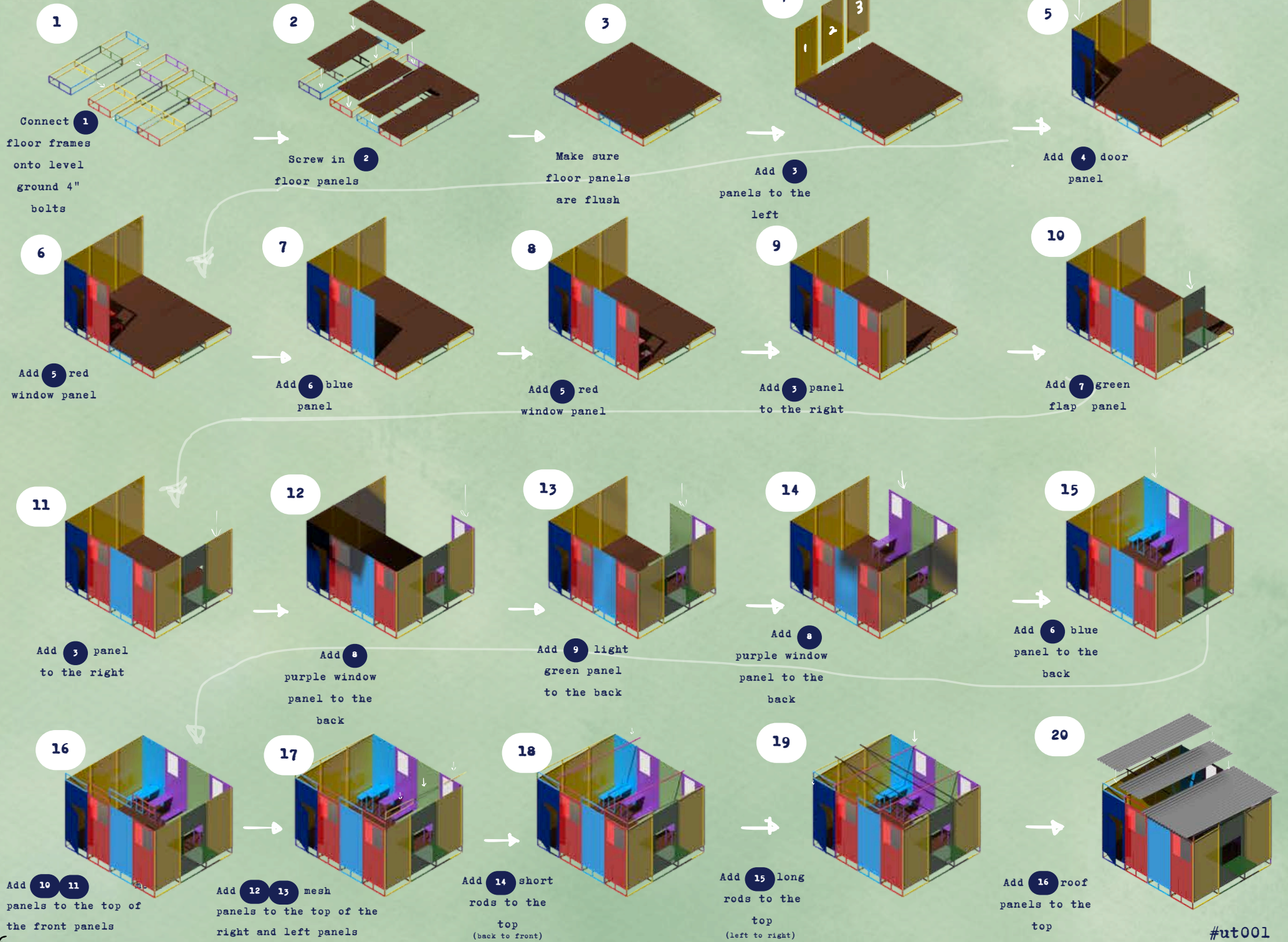

MODULAR DESIGN

Modular Design
can be made in multiple
configurations for different
functions

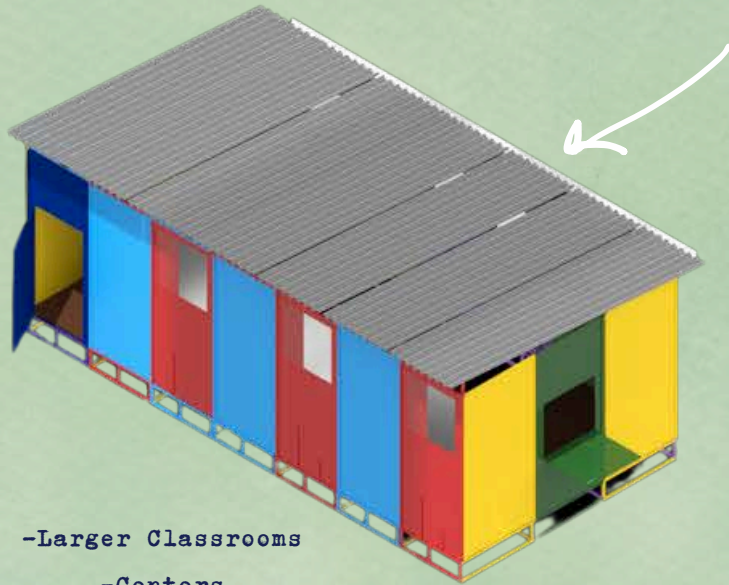

- Larger Classrooms
- Centers
- Shops

*suggestions

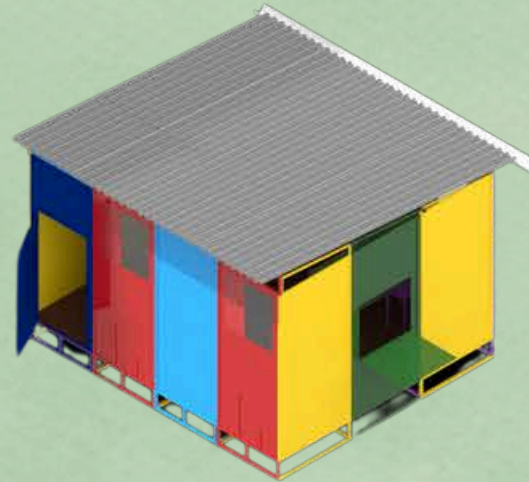

- Standard Classrooms
- Kitchens
- Offices

*suggestions

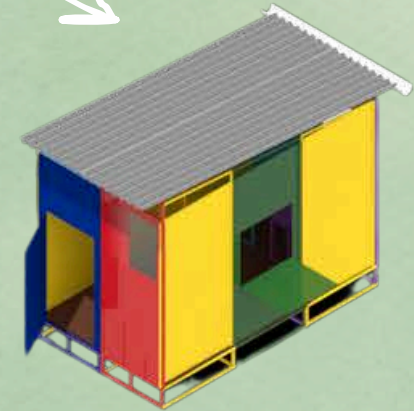

- Toilets
- Stores

*suggestions

Raised by lift mesh panels to allow for temperature regulation, cooling and light.

1

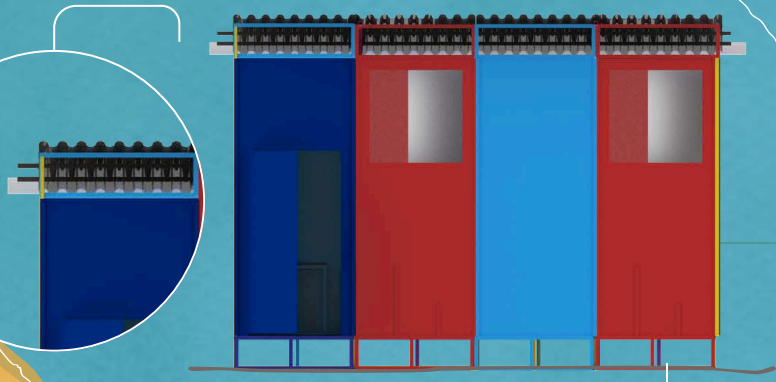

FEATURES

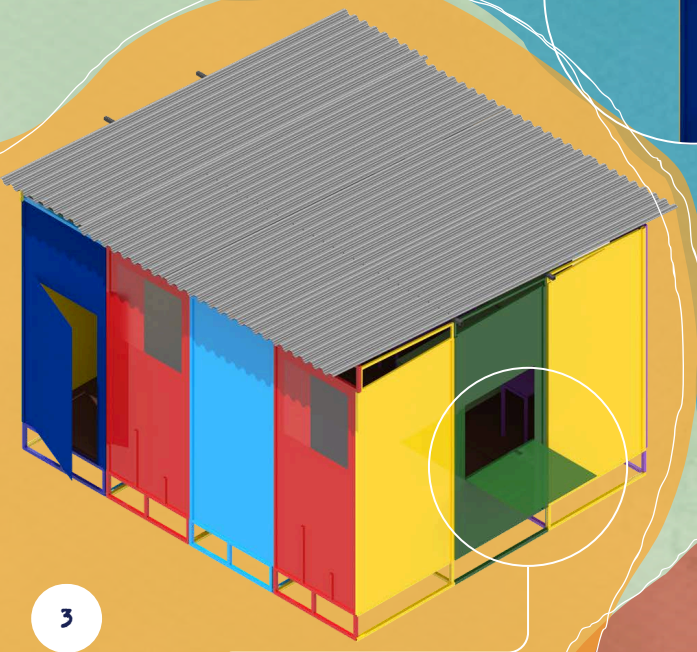

3

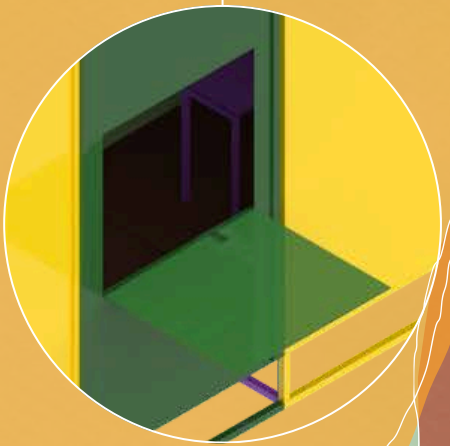

Distribution panel

4

Optional water collection gutter system

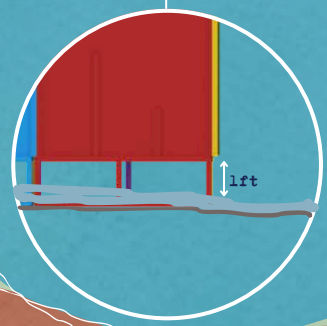
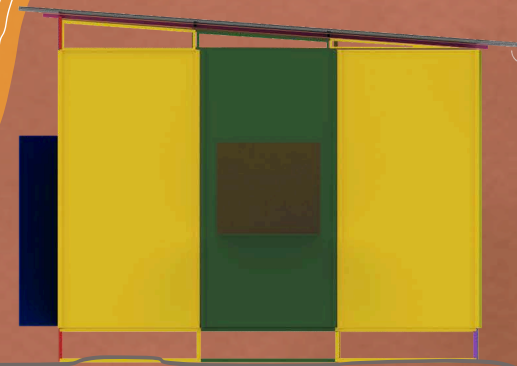
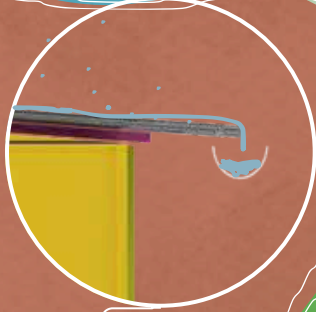

2

Raised to protect from rains and insects

5

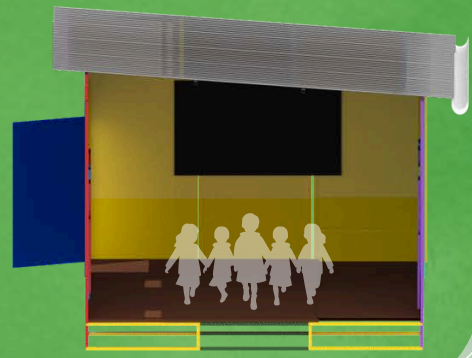
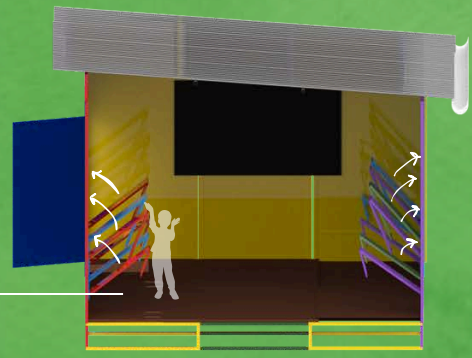
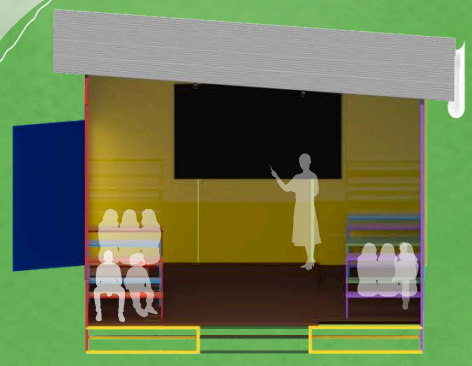

Desk folds up, to create adaptable spaces and easier for transportation

Name	Quantity	Dimensions			Cost	Total
		Width	Length	Thickness		
Square Tube	50	40mmx40mm	6m	1.2mm	1,300.00	65,000.00
Square Tube	35	25mmx25mm	6m	1.2mm	900.00	31,500.00
Angle Line	2	40mmx40mm	6m	3mm	1,600.00	3,200.00
Round Tube	1			10mm	1,200.00	1,200.00
Black Sheet Mabati	20			0.8mm	2,300.00	46,000.00
Perspex Sheet	1	8ft x 4 ft		0.5mm	10,000.00	10,000.00
Wire Mesh Expanded	1	8ft x 4 ft		1.5mm	3,000.00	3,000.00
Marine Board	7	8ft x 4 ft			3,000.00	21,000.00
Bushes 6" Butterfly	2				250.00	500.00
Bushes 6" Small	32				100.00	3,200.00
Weld Rods (Packet)	1			3.2mm	1,000.00	1,000.00
Cutting Disk SALI	5			9 in	150.00	750.00
Grinding Disk UMBRA	2			7 in	200.00	400.00
Plastic Gutter PVC	1		5m		1,500.00	1,500.00
Gutter Clip PVC	4				200.00	800.00
Outlet PVC	1				500.00	500.00
End Cup PVC	2				200.00	400.00
Elbow PVC	3				200.00	600.00
Down Pipe PVC	1				700.00	700.00
Roofing Sheet 2.5m	14	Coloured	2.5m	30 gauge	1,250.00	17,500.00
Roofing Screw Self Drilling	200		2 inch	8mm	10.00	2,000.00
Bolts M 10	130		4 inch	10mm	50.00	6,500.00
Total Material Cost						217,250.00
Discounted Material Cost						210,000.00
Paint						7,000.00
Labour						50,000.00
Transport						5,000.00
GRAND TOTAL						272,000.00

£1700

PROTOTYPE 1

GITHOGORO SLUM NAIROBI, KENYA

JANUARY 2025







